

Spirovent® High Velocity Drain 14", 16", 18" Microbubble™ Eliminator and Dirt Separator

Job Name:
Engineer:
Contractor:
Representative:

Tag	Model	Flow	Size	Location

Side view diagram of the Spirovent High Velocity Drain. Dimensions shown include: D (top diameter), H2 (total height), h2 (height to the bottom of the float chamber), hs (height to the top of the float chamber), and E (height of the bottom flange).

Specifications:

Shell	Steel
Vent Head	Brass
Float	Non-Ferrous
Seal	Viton
O Ring	Viton
Skim Valve	Brass
Coalescing Medium	Copper
Ball Valve	Brass
Max. Working Pressure	150 psig
Max. Operating Temperature	270°F

Fabricated and stamped in accordance with ASME, Section VIII, Division 1.

Top view diagram of the Spirovent High Velocity Drain. Dimensions shown include: P.S. (pressure side) and LF (length of the float chamber).

Pipe Size	14"	16"	18"
D	28"	32"	36"
H2	140"	158"	176"
h2	64"	73"	82"
LF	45"	50"	56"
hs	20"	22"	22"
E	2"	2"	2"
Weight	2400	3280	4320
Max. GPM	4650	6050	7600
Model			
VHN----FA	1400	1600	1800

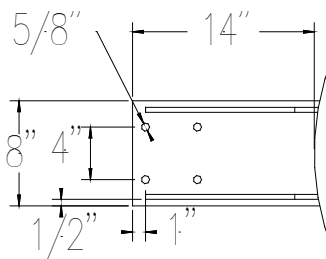

Support Bracket Detail

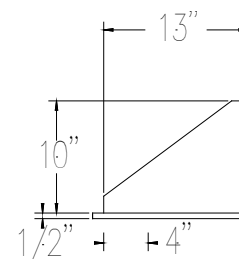

Support Bracket Detail