

### Spirovent® Drain 20", 24" Air Eliminator and Dirt Separator

Job Name:
Engineer:
Contractor:
Representative:

Tag	Model	Flow	Size	Location

Technical drawing showing the elevation of the Spirovent Drain. Dimensions include: D (overall diameter), H2 (total height), h2 (height to the bottom of the lower head), and hs (height to the top of the lower head).

**Specifications:**

Shell	Steel
Vent Head	Brass
Float	Non-Ferrous
Seal	Viton
O Ring	Viton
Skim Valve	Brass
Coalescing Medium	Copper
Ball Valve	Brass
Max. Working Pressure	150 psig
Max. Operating Temperature	270°F

**Notes:**  
Removable lower head to facilitate cleaning if required. Fabricated and stamped in accordance with ASME, Section VIII, Division 1 for unfired pressure vessels.

Technical drawing showing the cross-section of the Spirovent Drain. Dimensions include: PS (height of the side ports) and LF (length of the side ports).

Pipe Size	20"	24"
D	40"	48"
H2	134"	158"
h2	61"	73"
LF	61.4"	72"
hs	26"	26"
E	2"	2"
Weight (lbs)	4690	7240
Rec. GPM	5200	7500
Model		
VDN----FA	2000	2400

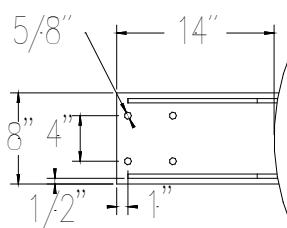

Bracket Detail

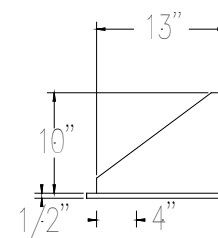

Bracket Detail